

GREEN SUPPLY BAG CHECKLIST

If you are missing any supplies, call the Election Officials Hotline: (216) 443-3277

Green Supply Bag | Loose Items

- Binder *(contents detailed below)*
- Green Folder *(contents detailed below)*
- Paper Pollbook Backup Pack *(contents detailed below)*
- VLM Cell Phone w/Instructions
- Blue Painter's Tape

Green Update Binder

- | | |
|--|---|
| <input type="checkbox"/> Alerts | <input type="checkbox"/> Password Envelopes |
| <input type="checkbox"/> Cable Lock Combination | ▪ EPB Passwords |
| <input type="checkbox"/> Drop-Off Location Information | ▪ Ballot Scanner Password |
| <input type="checkbox"/> Green Supply Bag Checklist | ▪ ADA Ballot Marking Device Passwords |
| <input type="checkbox"/> Important Phone Number List | <input type="checkbox"/> Security Records: |
| <input type="checkbox"/> Location Setup Diagram | ▪ Ballot Scanner Security Records |
| <input type="checkbox"/> Mandatory Calls to the BOE | ▪ Ballot Security Record |
| <input type="checkbox"/> Observer Packet (if any) | ▪ Location Security Record |
| <input type="checkbox"/> Post-Election Pack-up List | <input type="checkbox"/> VLM/VLD Checklist |
| <input type="checkbox"/> QRG Locator | |

Green Update Folder

- Precinct Voter List(s)
 - Post at entrance of location at 6:00 a.m. on Election Day.
- Payroll Card
- Candidate Withdrawal Notice (if any)

Clear Plastic Envelope

- Ballot Scanner Key on Lanyards
- Pen Pack Envelope
 - With plastic chamber seals and tamper tape
- Plastic Seals
- Yellow Maintenance Tags

Paper Pollbook Backup Pack

OPEN ONLY IF ALL ELECTRONIC POLLBOOKS ARE NOT OPERATIONAL!



Before opening the Paper Pollbook Backup Pack, you must call 216-544-8600 for authorization to use the Paper Pollbooks.

- | | |
|---|--|
| <input type="checkbox"/> Alphabetical Pollbooks | <input type="checkbox"/> Return Envelope |
| <input type="checkbox"/> Additional List of Registered Voters | <input type="checkbox"/> Provisional Voter Record Update |
| <input type="checkbox"/> Absentee Supplemental Update Report | <input type="checkbox"/> Paper Alphabetical Pollbook Process QRG |

ELECTRONIC POLLBOOK CASE CHECKLIST

If you are missing any supplies, call the Election Officials Hotline: (216) 443-3277

Electronic Pollbook (EPB) Case

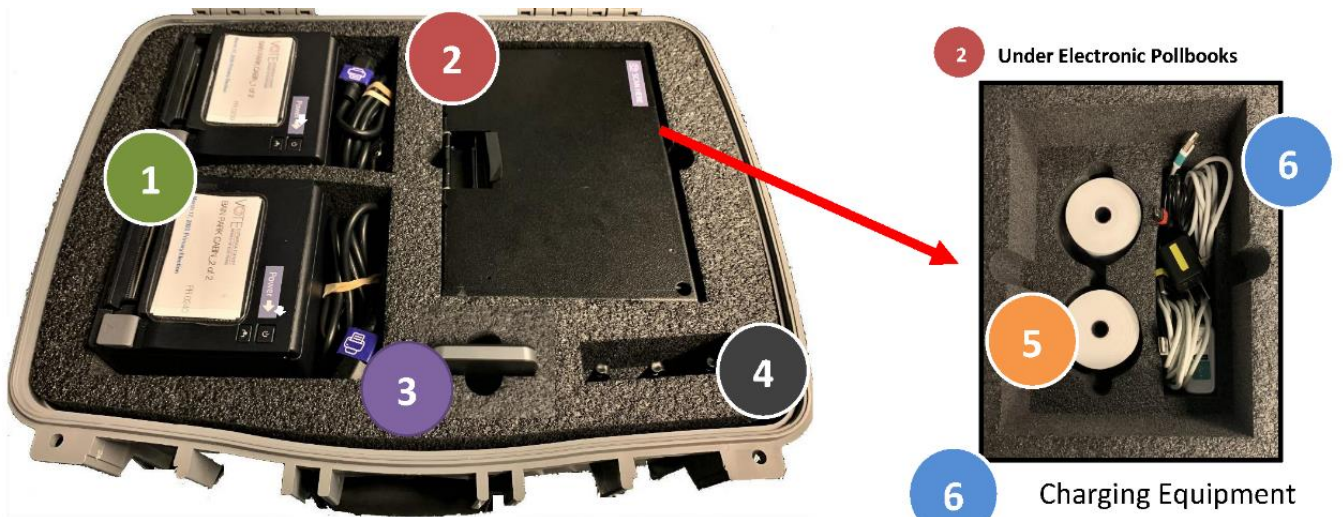

1 Printer w/ Power Cable (2) 4 Stylus (3)

2 Electronic Pollbooks (2) 5 Extra Printer Paper Rolls (2)

3 MiFi Hotspot (1)
(One Per Location)



6 Charging Equipment

EPB Cords (2)



MiFi Hotspot Cord (1)
(One Per Location)



MiFi Hotspot Plug (1)
(One Per Location)



EPB Charging Block (1)
(One Per Location)



- Electronic Pollbooks (iPads)
 - White Charging Cables
- Printers
 - Printer Power Cord
- Extra Printer Rolls
- MiFi Hotspot (1 per Location)
 - Charging Cable
- Stylus (3)
- Cleaning Cloth
- EPB Quick Reference Guides
- Troubleshooting Quick Reference Guide
- EPB Charging Block

NOTE: The Extension Cord and Surge Protector for the Electronic Pollbooks are in the bottom of one of the Ballot Scanner Compartments in your location.